

# ETHICS AND PERSONAL DATA PROTECTION TRAINING 18-19/06/19



CIREP-UPF



## AGENDA

### TUESDAY 18TH JUNE: Plenary session

15:30h

*Ethical Aspects in European  
Research Council Projects*  
Marie-Sophie Peyre - European  
Research Council Executive Agency

16:15h

*Ethical challenges during field  
studies of emerging technologies in  
sensitive settings.*  
Cosmin Munteanu - University of  
Toronto

17h

*Detecting Algorithmic Bias*  
Carlos Castillo - Universitat  
Pompeu Fabra

### WEDNESDAY 19TH JUNE (simultaneous activities)

9-17h

*A policy and practice-based workshop  
on avoiding and mitigating ethical traps  
in technocentric fieldwork (previous  
registration mandatory)*

9-13h

3 simultaneous advisory sessions on ethics  
& personal data protection in research led  
by CIREP and Marie-Sophie Peyre (ERCEA).  
(Previous registration mandatory)

# ETHICS AND PERSONAL DATA PROTECTION TRAINING 18-19/06/19

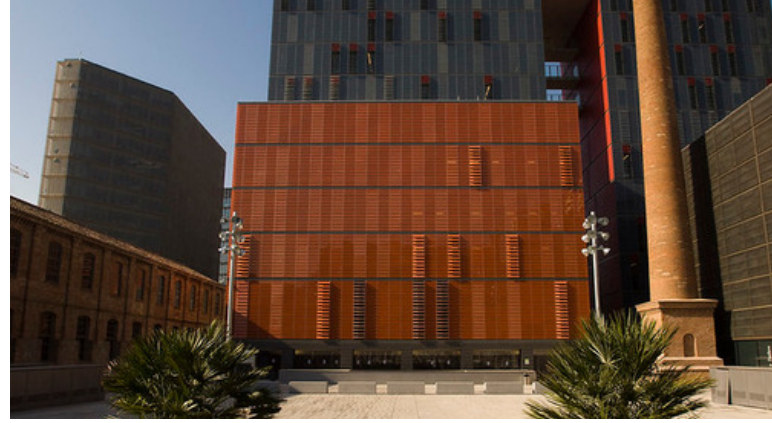

CIREP-UPF

## PRESENTATIONS ABSTRACT

### ***Ethical Aspects in European Research Council Projects - Marie-Sophie Peyre***

Marie-Sophie Peyre will present the main ethical and personal data protection concerns from the point of view of an Ethical Committee of the European Research Council Executive Agency.

### ***Ethical challenges during field studies of emerging technologies in sensitive settings - Cosmin Munteanu***

Most researchers are accustomed to the process of formal ethics review for their evaluation or field trial protocol. Although this varies by discipline, the underlying principles are universal and the process often a formality. However, for technocentric field research with vulnerable participants, formal ethics requirements can be challenging to navigate. The emergence of new interactive technologies and their application to sensitive contexts poses new ethical challenges. In this presentation, Cosmin will explain the key principles of the Canadian Tri-Council Policy on Ethical Conduct of Research, as a representative example of national policies governing the ethics of research with human participants. Cosmin will then discuss the gaps that exist between such policies and the challenges of conducting fieldwork of emerging technologies with vulnerable or marginalized users, exemplified by cases studies.

### ***Detecting Algorithmic Bias - Carlos Castillo***

Algorithms and decision making based on Big Data have become pervasive in all aspects of our daily (offline and online) lives. Social media, e-commerce, professional, political, educational, and dating sites, to mention just a few, shape our possibilities as individuals, consumers, employees, voters, students, and lovers. In this process, vast amounts of personal data are collected and used to train machine-learning based systems. These systems are used to classify and rank people, and can discriminate us on grounds such as gender, age, or ethnicity, even without intention, and even if legally protected attributes, such as race, are not explicit in the data. Algorithmic bias exists even when there is no discrimination intention in the developer of the algorithm. Sometimes it may be inherent to the data sources used, but even when the sensitive attributes have been suppressed from the input, a well trained machine learning algorithm may still discriminate on the basis of such sensitive attributes because of correlations existing in the data.

## WORKSHOP ABSTRACT

In this highly-interactive workshop we will examine particular case studies (proposed by the facilitator and by the attendees) that exemplify challenges or dilemmas we are facing in designing and conducting technocentric (field) research in an ethical manner, particularly with vulnerable participants or in sensitive settings. We will discuss how existing policies and guidelines can be interpreted and applied to fieldwork on emerging technologies. We ground this in our collective experiences with ethically-difficult research. To guide the interpretation of the discussed case studies, we will use as an exemplar framework one of the most comprehensive policies on ethics in research with human participants - the Canadian Tri-Council Policy Statement. Familiarity with this policy framework is not required, as part of the workshop will be dedicated to a hands-on interpretation of relevant examples from the framework, using representative case studies.

CIREP CONTACT: [SECRETARIA.CIREP@UPF.EDU](mailto:SECRETARIA.CIREP@UPF.EDU)

# ETHICS AND PERSONAL DATA PROTECTION TRAINING 18-19/06/19



CIREP-UPF



## SPEAKERS

**Marie-Sophie Peyre** is a scientific adviser in ethics at ERCEA - European Research Council Executive Agency-. Marie-Sophie is an experienced specialist on the analysis of research projects' aim and methodology to ensure their compliance with European legislation and values. She is also an expert on drafting of the elements linked to ethics in the framework program Horizon 2020. As an adviser in ethics at ERCEA, she contributes to the definition of topical sensitive elements in ethics issues and to the enhancement of the integration of human sciences in research ethics. She has studied public law in Paris (University Paris I - Panthéon –Sorbonne) with a special focus on human rights, moral and ethics and is a barrister. She also graduated from the Cycle des hautes études européennes of Ecole nationale d'administration (ENA). She has worked during seven years as a judge for the United Nations High commissioner for refugees. She had previously worked during four years for Robert Badinter, former President of French constitutional Council and former Minister of Justice.

**Cosmin Munteanu** is an Assistant Professor at the Institute for Communication, Culture, Information and Technology at University of Toronto Mississauga, and Director of the Technologies for Ageing Gracefully lab at University of Toronto. Prior to joining the University of Toronto Mississauga, he was a Research Officer with the National Research Council (NRC). His area of expertise is at the intersection of Human-Computer Interaction, Automatic Speech Recognition, Natural User Interfaces, Mobile Computing, Ethics in Computing Research, Assistive Technologies, and Gerontechnology. Currently, Cosmin serves as a full member of the ACM SIGCHI Ethics Committee, where he provide guidance on ethical issues emerging from papers submitted for review to SIGCHI-sponsored conferences. Additionally, he has conducted and published research on the ethical conduct of research with human participant in emerging techno-centric fieldwork. URL: <http://cosmin.taglab.ca>

**Carlos Castillo** is a distinguished Research Professor at Universitat Pompeu Fabra in Barcelona. He is a web miner with a background on information retrieval, and has been influential in the areas of web content quality and credibility, and adversarial web search. He is a prolific researcher with more than 80 publications in top-tier international conferences and journals, receiving 13,000+ citations. His works include a book on Big Crisis Data, as well as monographs on Information and Influence Propagation, and Adversarial Web Search.

CIREP CONTACT: [SECRETARIA.CIREP@UPF.EDU](mailto:SECRETARIA.CIREP@UPF.EDU)