

RESEARCH FORUM 2017

Department of Political and Social Sciences

Thursday, February 9th at 15:00

Room 40.253. Roger de Llúria Building

Roger Giner-Sorolla, University of Kent

will present

Emotions Represent Social Value



Abstract:

The presentation will argue that social emotions, specifically shame, guilt, disgust and anger, serve the purpose of tracking the social value of other people (anger, disgust) and of tracking how other people see the social value of the self (guilt, shame). Moreover, anger and guilt seem adapted to track momentary social value focused on acts, while disgust and shame track chronic social value focused on a person's enduring character. I will present studies in press or under review from our lab that demonstrate how disgust has more to do with perceived moral character than anger; how disgust also communicates moral character more strongly than anger; and how shame functions to represent the general image that many people have of us, while guilt functions to represent temporary judgments of acts that close people form of us.

Short bio:

Roger Giner-Sorolla is Professor of Social Psychology at the University of Kent in southeast England, where he has worked since 2001. He received his Ph. D. at New York University and has family roots in England and in Vinaròs (Castelló). His research has focused on attitudes, affect and emotions, in particular emotions that respond to and guide moral judgment such as anger, disgust, guilt and shame. He is also interested in the role of emotions in group perception. A more recent interest is increasing the reproducibility and evidence standard of social psychology as a discipline, which he pursues in his current role as editor-in-chief of the Journal of Experimental Social Psychology. He is author of numerous articles and of a 2012 monograph, “Judging Passions: Moral Emotions in Persons and Groups.”

.

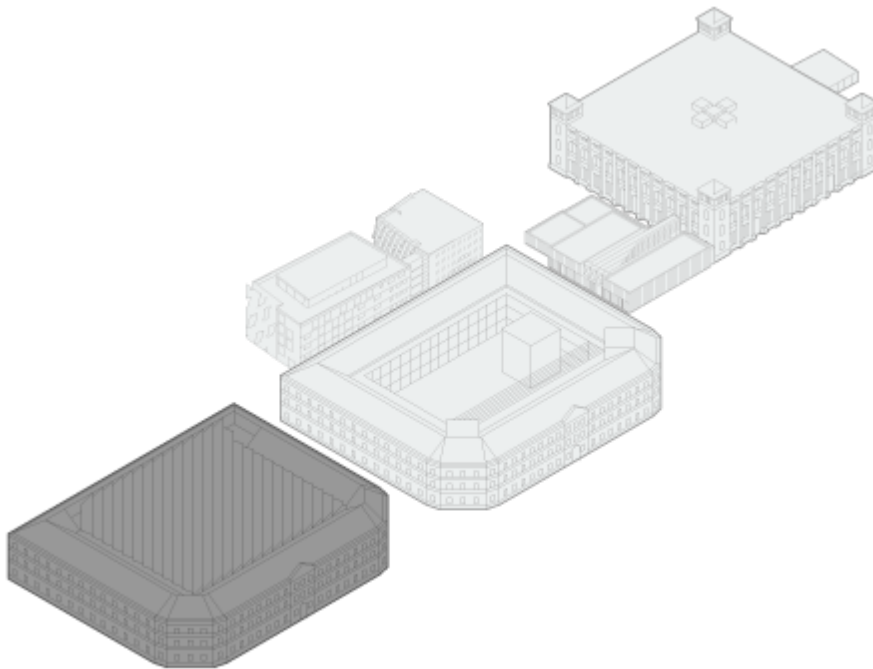
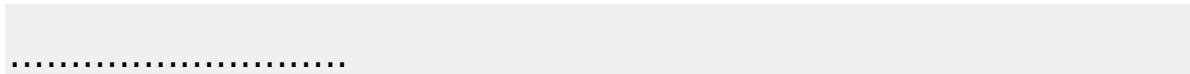

Coordination: Visnja Vukov (visnja.vukov@upf.edu)